

12 GA STEEL STAMPED SHELL WITH 12 GA. FORMED HORIZONTAL MOUNTING CHANNELS AND A 10 GA. FORMED VERTICAL CHANNEL WELDED TO REVERSE SIDE.

BOARD THICKNESS IS 1 1/2".

BOARD IS POWDER COATED GLOSS WHITE WITH ORANGE TARGET & BORDER.

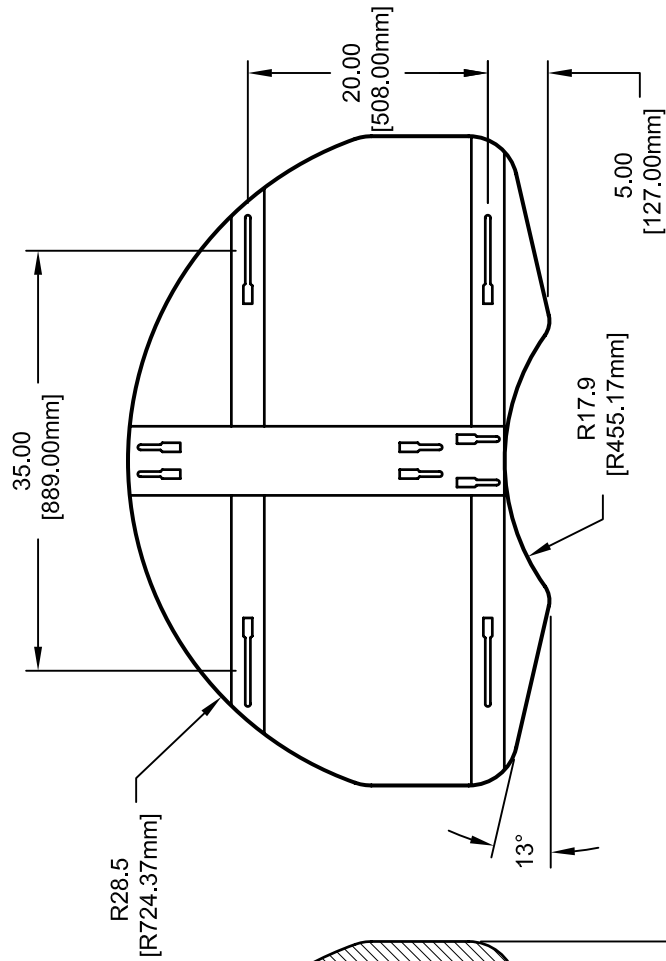

REAR VIEW

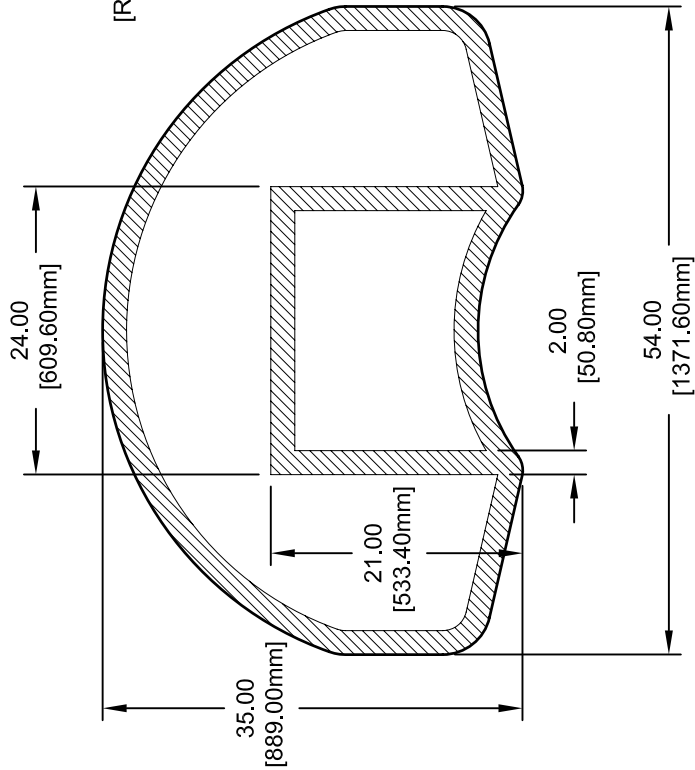

FRONT VIEW

REVISION		
REV.	DATE	BY
A	12/01/03	JJC
B	12/15/06	WAE
C	06/05/08	RWP



**Gared Holdings, LLC**  
9200 E. 146th St. Noblesville, IN 46060

THIS DOCUMENT CONTAINS TRADE SECRET AND OTHER MATERIALS WHICH ARE PROTECTED BY CONFIDENTIALITY NOTICE AND AGREEMENT AND BY COPYRIGHT. ANY USE OR COPYING OF THIS DOCUMENT EXCEPT AS AUTHORIZED BY GARED HOLDINGS, LLC IS STRICTLY PROHIBITED.

**FAN SHAPED STEEL BACKBOARD**

DRAWN	CONNERLEY	DATE	05/02/03	MATERIAL	AS NOTED
APPROVED	JJC	DATE	05/02/03	FINISH	AS NOTED
FILE LOC. Q:\Final Release\Specifications				DWG. NO.	1266B
SIZE	SCALE	SHT. NO.	PART NO.	REV	
A	NOTED	1 OF 1	1266B	C	



## **MODEL 1266B**

### **35" X 54" FAN SHAPED STEEL BACKBOARD FOR REAR MOUNT GOALS**

1266B backboard shall be formed from a single piece of heavy gauge steel and reinforced with a heavy gauge vertical center channel and heavy gauge horizontal channels. All reinforcing sections shall be welded to the shell to make a single vibration free unit. Key-slots in the horizontal channels shall be spaced at 20" vertical and 35" horizontal centers to match the standard fan mounting dimensions. Backboard shall be phosphate pre-treated and shall have a durable white powder coat finish to protect against weathering. Orange border and target shall be silk-screened on face of backboard for permanent markings. Goal mounting holes in rear channel shall be standard reverse mount pattern and shall accept reverse mount goals.

#### **ACCESSORIES**

#### **GOALS**

Compatible goals are models 66T, 266, 4066, and 6600. See goal section in specification manual.