

FURRING STRIPS  
BY OTHERS

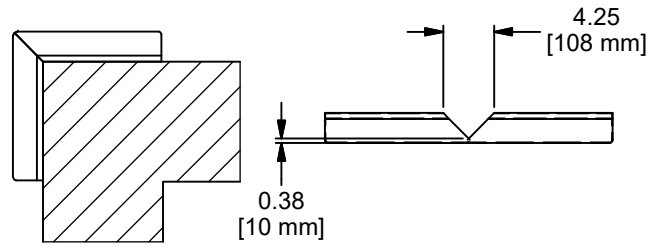

OUTSIDE CORNER DETAIL

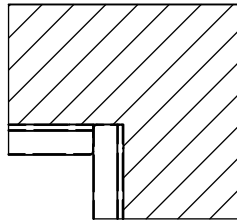

INSIDE CORNER  
LAP DETAIL

Part number	"A" Dim	"B" Dim
4120-STD	5'-10" [1778mm]	6'-0" [1829 mm]
4120-NSD	6'-10" [2082 mm]	7'-0" [2134mm]
4120-NSD	7'-10" [2388 mm]	8'-0" [2438 mm]

14 OZ. MIN. POLYESTER LAMINATED  
VINYL (19 OZ POLYESTER LAMINATED  
VINYL OPTIONAL).

ATTACHED TO BACKING WITH  
STAPLES EVERY 2.00" [50.8 mm]

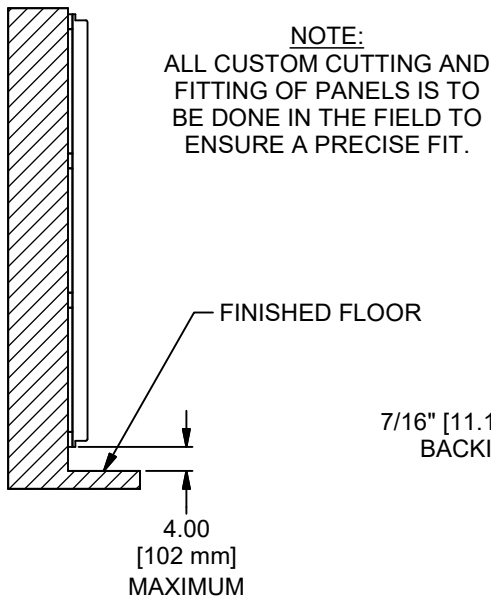

**NOTE:**  
ALL CUSTOM CUTTING AND  
FITTING OF PANELS IS TO  
BE DONE IN THE FIELD TO  
ENSURE A PRECISE FIT.

FINISHED FLOOR

4.00  
[102 mm]  
MAXIMUM

7/16" [11.11 mm] OSB  
BACKING BOARD

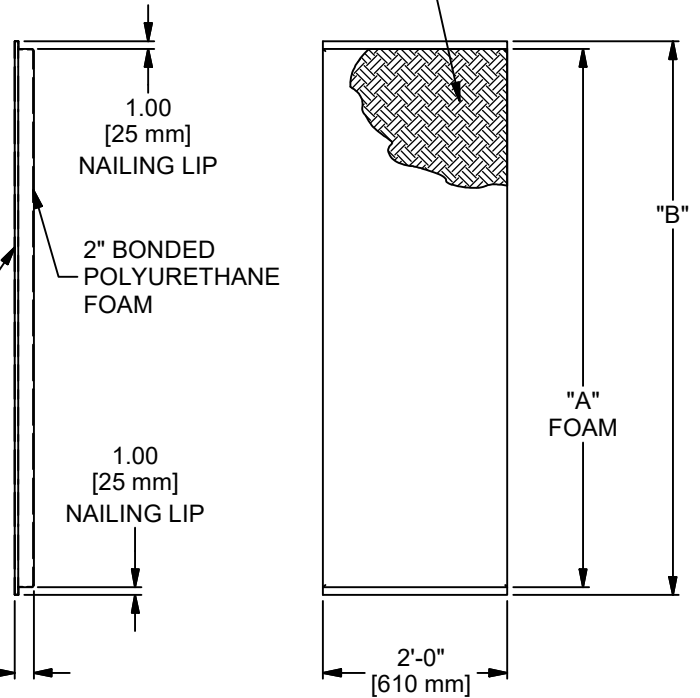

1.00  
[25 mm]  
NAILING LIP

2" BONDED  
POLYURETHANE  
FOAM

1.00  
[25 mm]  
NAILING LIP

2.50  
[64 mm]

"A"  
FOAM

"B"

2'-0"  
[610 mm]

**WARNING**

DO NOT INSTALL PADS MORE THAN 4" ABOVE  
THE FINISHED FLOOR. INSTALLING PADS  
ABOVE 4" CAN RESULT IN BODY CONTACT  
WITH THE WALL AND PERSONAL INJURY.



Gared Performance Sports Systems

9200 E. 146th Street, Suite A  
Noblesville, IN 46060

THIS DOCUMENT CONTAINS TRADE SECRET AND OTHER MATERIALS WHICH ARE  
PROTECTED BY CONFIDENTIALITY NOTICE AND AGREEMENT AND BY COPYRIGHT.  
ANY USE OR COPYING OF THIS DOCUMENT EXCEPT AS AUTHORIZED BY GARED  
PERFORMANCE SPORTS SYSTEMS IS STRICTLY PROHIBITED.

IMPACT2440BND WALL PAD, 2" BONDED

DRAWN CONNERLEY DATE 4/17/2013 DATE ISSUED

APPROVED DATE

FILE LOC. Q:\Inventor Files\

SIZE <b>A</b>	SCALE NONE	SHT. NO. 1 OF 2	PART NO. <b>4120</b>	REV <b>C</b>
------------------	---------------	--------------------	-------------------------	-----------------

C	MJP	06/09/22
B	MJP	01/28/22
A	JJC	11/20/17
REV	BY	DATE



## MODEL 4120

### **IMPACT2440BND WALL PADDING**

Wall padding standard size (Part number 4120-STD) shall be 6' [1.82 m] x 2' [0.9 m] with 1" [25.4 mm] nailing margin with height options (Part number 4120-NSD) available for both 7' [2.134 m] x 2' [0.9 m] and 8' [2.438 m] x 2' [0.9 m] with 1" [25.4 mm] nailing margin on top and bottom of each panel. Nailing margin reduces foam height from 6' [1.8 m] to 5'-10" [1.77 m], 7' [2.134 m] to 6'-10" [2.083 m], and 8' [2.44 m] to 7'-10" [2.39 m] respectively. Pads shall be constructed using 2" [50.8 mm] thick 6 lbs. density bonded polyurethane foam cemented to 7/16" [11.11 mm] oriented strand board.

Cover material shall be 14-ounce polyester laminated vinyl (19-ounce polyester laminated vinyl optional) stapled to backing every two inches. Vinyl to be flame retardant material, which meets NFPA 701, ASTM E84, and CSFM (California State Fire Marshall). Vinyl shall be available in white, yellow, orange, red, kelly green, forest green, royal blue, marine blue, navy blue, gray, black, burgundy, beige, and purple.

Custom cutting and fitting of padding may be done in field to ensure proper fit. Furring strips by others.

Product tested per ASTM F1292-09 and meets all requirements of ASTM F2440-11.

#### **ACCESSORIES**

#### **WALL ATTACHMENT TRIMS AND HARDWARE**

Most wall padding may be attached with special attachment trims and hardware. See the wall padding section in the specification manual.

Subject to design change and current manufacturing practices.